

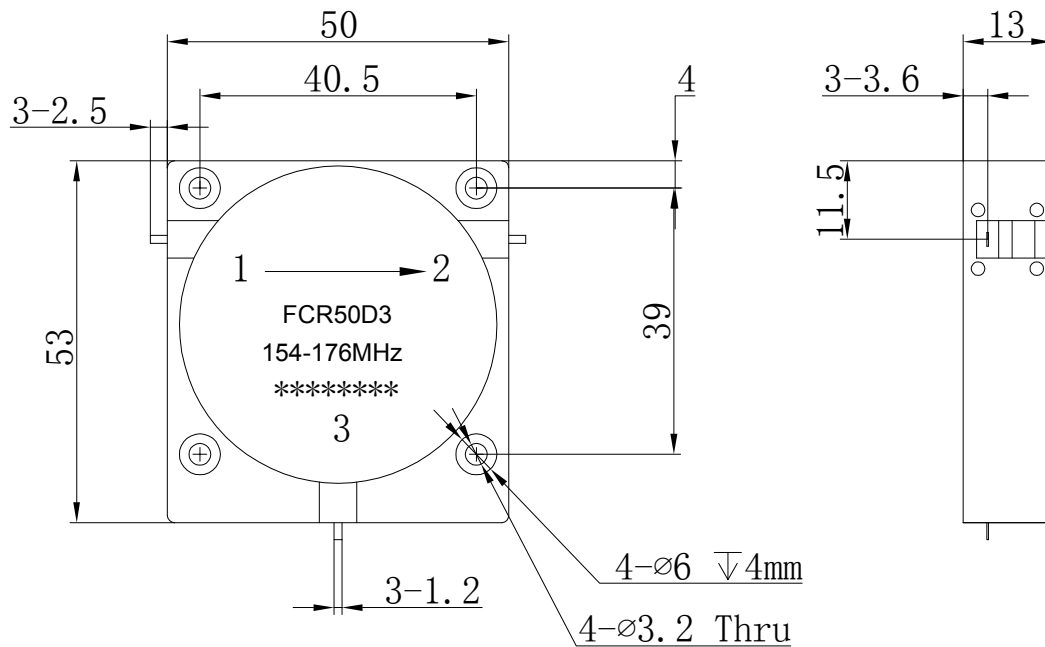

Drop-in Circulator

FCR50D3 154-176MHz



- Note:
- 1.Tolerances:  $\pm 0.20\text{mm}$
  - 2.Material  
BODY: Steel  
TAB: BeCu
  - 3.Surface Treatment  
BODY: Nickel plate  
TAB: Silver Plated

Item	Unit	Specification	Note
Freq.Range	MHz	154-176	
Direction		CW/Right	
Operating Temperature	°C	0~+60	
Insertion Loss	dB max	0.6	Room Temp (+25°C ± 10°C)
	dB max	0.6	Over Temp (-10°C ~ +70°C)
Isolation	dB min	18	Room Temp (+25°C ± 10)
	dB min	18	Over Temp (-10°C ~ +70°C)
Return Loss	dB min	18	Room Temp (+25°C ± 10)
	dB min	18	Over Temp (-10°C ~ +70°C)
Avg Power	W	100	
Impedance	Ω	50	

Customer suggestion and confirmation:

Signature:

Date:

Design: Colin

Format Scale Version

A4 1:1 A

Date: 2019.1.16

Page 1, Total 1

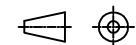

Unit: mm

www.winnsky.com