

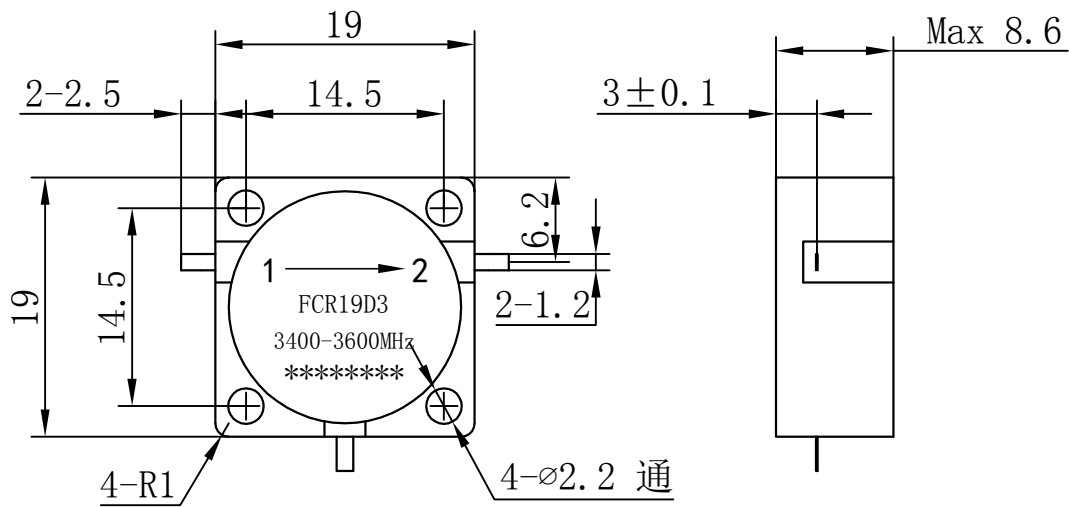

Drop-in Circulator

FCR19D3 3400-3600MHz



Note:

- 1.Tolerances: $\pm 0.20\text{mm}$
- 2.Material
BODY: Steel
TAB: BeCu
- 3.Surface Treatment
BODY: Nickel plate
TAB: Silver Plated

Item	Unit	Specification	Note
Freq.Range	MHz	3400-3600	
Direction		CW/Right	
Operating Temperature	°C	-40~+105	
Insertion Loss	dB max	0.25	Room Temp (+25°C ± 10°C)
	dB max	0.30	Over Temp (-40°C ~ +105°C)
Isolation	dB min	25	Room Temp (+25°C ± 10)
	dB min	22	Over Temp (-40°C ~ +105°C)
Return Loss	dB min	25	Room Temp (+25°C ± 10)
	dB min	22	Over Temp (-40°C ~ +105°C)
Avg Power	W	260	
Peak Power	W	1000	
Impedance	Ω	50	

Customer suggestion and confirmation:

Signature:

Date:

Design: Colin

Format Scale Version

A4 1:1 A1

Date: 2020.4.2

Page 1, Total 1



Unit: mm

www.winnsky.com